

Our Condensing Pieces are:

- very tight - designed to save space compared to other condensate collection solutions
- equipped with a gutter elbow that is compatible with conventional condensate drainage hoses
- made of PETG material, thus minimising the formation of thermal bridges
- designed to be installed in vertical and horizontal pipes (horizontal pipes must always be in a gradient towards the drain)
- efficient, depending on the flow rate and type of pipe material, they are able to collect up to 91% of condensed moisture
- manufactured in three variants (for EPE, EPS and SPIRO pipes)

Made of PETG material:

- which is flexible and solid
- has high impact resistance and durability
- is made from health-safe materials
- has low shrinkage on cooling
- is 100% recyclable

Package includes:

Condensation piece, 2 sealing rings for the SPIRO version, manual. Packed in a box or foil.

Coding:

LT - TR - XXX - YYY

- Dimension: 80, 100, 125, 150, 160, 170, 180, 200 mm
- Duct Type: EPE, EPS, SPIRO
- Trap
- LUFTool

Dimensions:

EPE + EPS

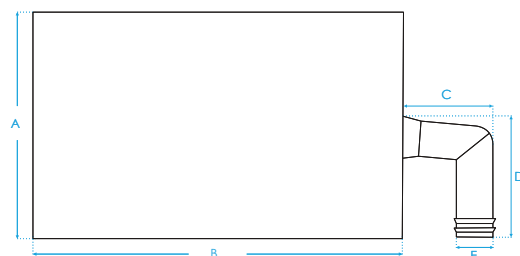

SPIRO

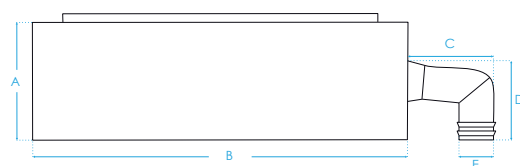

LUFTool Trap products are designed to collect condensed water on the inside of the pipe in the ventilation systems. They are usually installed on pipes that blow air from the interior through the unheated part of the house. The condensation piece drains condensate from the duct walls outside the duct.

Basic Types:

ID: LT-TR-EPE-YYY



ID: LT-TR-EPS-YYY



ID: LT-TR-SPI-YYY



units (mm)	LT-TR-EPE-	A	B	C	D	D2	D3	E
	125	100	130	40.5	54.3	-	98	16
	150	100	155	40.5	54.3	-	123	16
	160	100	166	40.5	54.3	-	134	16
	180	100	185	40.5	54.3	-	153	16
	200	100	207	40.5	54.3	-	175	16

units (mm)	LT-TR-EPS-	A	B	C	D	D2	D3	E
	125	100	125	40.5	54.3	-	93	16
	160	100	160.5	40.5	54.3	-	128	16
	200	100	200.5	40.5	54.3	-	168.5	16

units (mm)	LT-TR-SPI-	A	B	C	D	D2	D3	E
	80	55	65.6	40.5	37	68	65.6	16
	100	55	85.6	40.5	37	88	85.6	16
	125	55	110.6	40.5	37	113	110.6	16
	150	55	135.6	40.5	37	138	135.6	16
	160	55	145.6	40.5	37	148	145.6	16
200	55	185.6	40.5	37	188	185.6	16	

LUFTool Trap Video



Pressure Drop Values ΔP (Pa):

$P_{tot} = P_{stat} + P_{dyn}$
 Values for supply and exhaust air.

LT-TR-SPI-	Air flow (m³/h)							
	50	100	150	200	250	300	350	
100	3.0	12.0	27.0	48.1	75.1			
125	1.2	4.9	11.1	19.7	30.8			
160	0.5	1.8	4.1	7.3	11.5	16.5	22.5	
200	0.2	0.8	0.8	3.0	4.7	6.8	9.2	

Measured according to: EN ISO 12238
 Measured for a reference air density of 1,2 kg/m³.

Installation of Luffool Trap SPIRO Type:

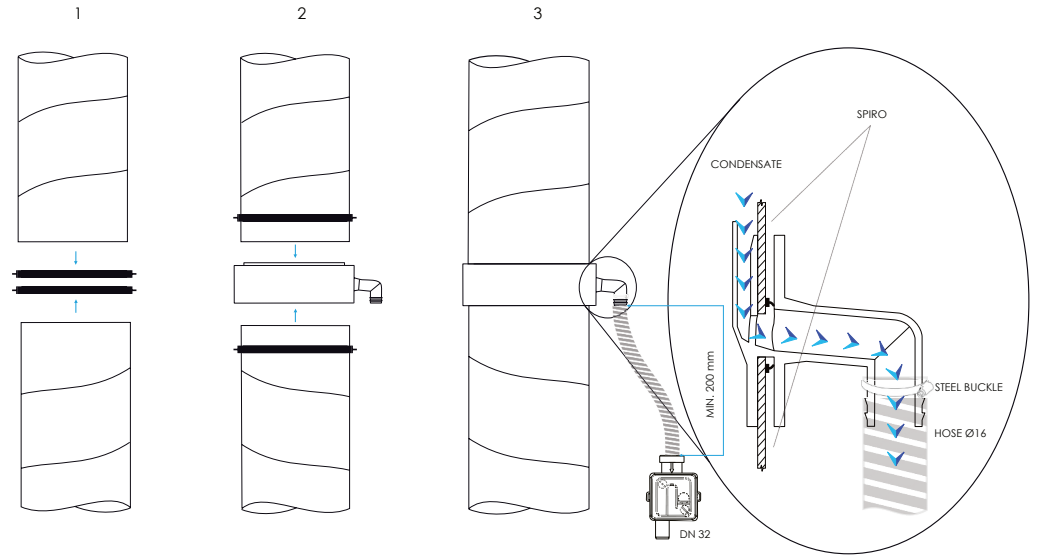

Principle of Condensation:

When moisture condenses in the duct, water droplets form on the inside surface of the duct and flow along the perimeter into the inner collar of the LUFFTool Trap. Under suitable conditions, the condensation piece captures most of the flowing water and directs it out of the ventilation system. The movement of water in the duct can affect turbulent airflow and other components in the duct (elbows, caps, dampers, etc.). Always consult with an HVAC designer before use.

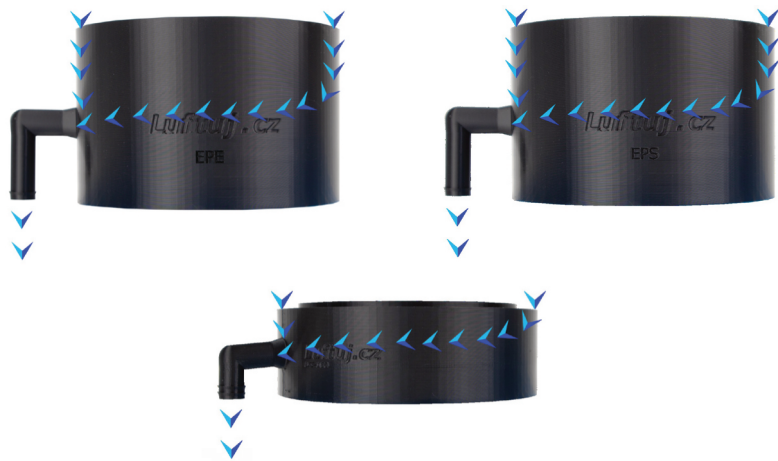

Accessories:



Spiro Duct 100, 125, 150, 160, 200) 3 m
 ID: SPIRO-XXX



EPE Duct 2m - 125, 150, 180, 160, 200 mm
 ID: HRWTW-XXX-2m



Condensate Drain Hose
 ID: KOND16

MADE IN CZECH REPUBLIC
 LUFFTool Trap

